

PRODUCT SELECTION GUIDE

500-010 EMI Backshells With Circular Cable Entry

Always in stock, these one piece aluminum backshells are our most popular Micro-D backshells. Terminate cable shields with BAND-IT® stainless steel straps. Finish the cable with heat-shrink tubing or boots, sold separately. Stocked in top, side and 45° entries. Accepts standard and micro shield bands.



500T010
Page M-6



500S010
Page M-6



500E010
Page M-6

Elliptical Entry EMI Micro-D Backshells for Larger Wire Bundles

If your wire bundle exceeds the diameter of the circular entry backshells, then the answer is an elliptical entry backshell. See the table on page L-5 for more information on wire bundle sizes. Choose one piece or split elliptical shells.



One Piece Top Entry
500-047
Page M-12



One Piece Top, Side and 45°
507-175
Page M-19



Split Top Entry, with Screwlocks
507-178
Page M-21

Composite EMI Micro-D Backshells

These nickel-plated thermoplastic backshells offer weight savings compared to aluminum versions.



Composite
507-088
Page M-14

EMI Micro-D Backshells With Braid Attached

These backshells are terminated to tinned copper braid.



Shield Sock
500-011
Page M-8

Split EMI Micro-D Backshell With Circular Entry and Screwlocks

This backshell features screwlocks, allowing the connectors to be fully mated before the hardware is fastened.



Split Screwlock
507-145
Page M-17

EMI Dual Entry Micro-D Backshells

These backshells allow 2 cables to be secured with bands.



45°
500D010
Page M-6



Top Entry
507-142
Page M-16

Strain Relief Backshells (not for EMI)

These backshells are used for wire or cable strain relief. Three styles are provided.

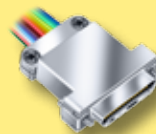

Bar Clamp
507-198
Page M-23



Bar Clamp
507-146
Page M-18



Tie Wrap
500-012
Page M-10

Potting Shell

Potting shells are attached to the connector and filled with epoxy or similar encapsulants to provide environmental protection and strain relief.



Potting Shell
507-035
Page M-13

Switching Shell

Switching shells are used to house connector wiring on the back of the connector.



Switching Shell
500-016
Page M-11



Micro-D Backshells General Information and Product Selection Guide

MICRO-D BACKSHELL SELECTION GUIDE

	MICRO-D BACKSHELL SELECTION GUIDE											Page Number									
	EMI backshell	Available in Lightweight Composite	Strain Relief Backshell	Potting Shell	Switching Shell	Circular Cable Entry	Elliptical Cable Entry	Straight Cable Entry	45° Cable Entry	Side Cable Entry	Slot Head Jackscrews		Hex Head Jackscrews	Extended Jackscrews	Screw Locks Instead of Jackscrews	One Piece Backshell	Split (Two Piece) Backshell	Accepts Standard Shield Band	Connector Attaches with Clip	Connector Attaches with E-Ring	Connector is Captivated by Backshell
500-010	●					●	●	●	●	●	(1)	●		●	●	●					L-6
500-011	●					●	●	●	●	●	(1)	●				●					L-8
500-012		●				●	●	●	●	●	(1)	●				●					L-10
500-016				●								●				●					L-11
500-047	●					●	●			●	●	●		●	●	●					L-12
507-035			●							●	●	●				●					L-13
507-088	●	●				●	●	●	●	●	(1)	●			●	●					L-14
507-145	●					●						●	●	●		●			●		L-17
507-146		●								●	●	●	●		●	(2)	(2)				L-18
507-175	●					●	●	●	(3)	●	●	●	●		●	●					L-19
507-178	●					●	●					●		●	●				●		L-21
507-198		●					●			●	●	●			●						L-23

- (1) Extended jackscrew will not work with 45° cable entry or with dual 45° entry backshells.
- (2) Sizes 9 thru 69 use e-rings or c-clips for connector attachment, 100 pin uses c-clip only.
- (3) The cable entry is on the long side of shell. See ordering information for clarification.

GLENAIR QWIK CONNECTIONS

	500-010	500-011	500-012	500-016	500-047	507-035	507-088	507-145	507-146	507-175	507-178	507-198
Same Day Stock*	A	C	A	C	A	A	C	B	A	D	D	D
Lightest Weight						●						
Accepts Standard Width Shield Band	●				●							
Meets NASA Outgassing	●	●	●	●	●	●	●	●	●	●	●	
Low Residual Magnetism							●			●		
Oversize Elliptical Cable Entry				●					●	●		
Split Backshell With Screwlocks for Fast Mating							●			●		

*Availability: **A** — All sizes in stock. **B** — Most sizes in stock. **C** — A few sizes in stock. **D** — Not Stocked.

ABOUT MICRO-D BACKSHELLS

Micro-D EMI backshells connect cable shields to Micro-D connectors, providing strain relief and mechanical protection. These backshells are made out of aluminum alloy. Electroless nickel is the most widely used finish. These backshells are compatible with industry- standard metal shell M83513 type connectors. The following application notes explain how to select the right type of backshell.

EMI Versus Non-EMI Backshells

Select EMI backshells if your cable has a braided copper shield. The cable shield is secured to the backshell with a **BAND-IT®** strap, supplied with the backshell or purchased separately.

Select a strain relief backshell if your connector has individual wires or if your wire bundle does not have a metal shield.

EMI backshells do not normally require additional strain relief. Micro-D wires are typically potted, and the shield braid is a sufficient strain relief. An optional ty-wrap leg is available if necessary. Add "S" to the end of the part number.

**Band Platform
For EMI Shield**

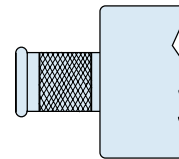

Qwik-Ty Option
Add "S" to Part
Number

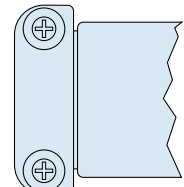
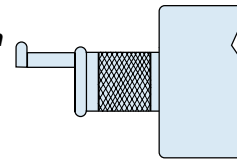

**Strain Relief
Clamp**

Standard Band Versus Micro Band

Most Micro-D EMI backshells feature low profile band platforms designed for narrow (.125" width) micro band. Some have a taller band platform which also accepts standard bands (.250" width). Please refer to the "Backshell Selection Guide" on the preceding page to identify which backshells are compatible with both the standard band and the micro band.

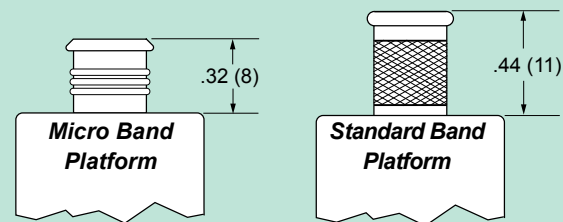

One Piece Backshell Versus Split Backshell

Use one piece backshells if in stock availability is important. Split backshells allow installation after the other end of the cable has been terminated. Some split backshells fit over the connector, eliminating the highly magnetic clip. Split versions also can accommodate screw locks.

Jackscrews and Screwlocks

Jackscrews are fixed in position and must be turned in order to mate the connectors together. Screwlocks float and allow the connectors to be coupled before the screwlocks are engaged. Screwlocks allow faster mating, while jackscrews offer less risk of contact damage.

Elliptical Versus Circular Cable Entry

Choose elliptical backshells if the wire bundle diameter is too big to fit in a circular cable entry. Large Micro-D connectors (51 pins and up) usually exceed the limits of the round entries. Refer to the cable entry and wire bundle tables in this section to find out if an elliptical entry is necessary.

The actual size illustrations to the right show the difference between round and elliptical cable entries. The round entry circular mil area = $\pi(\frac{1}{2}D)^2 = .11 \text{ In.}^2$. The formula for the area of an ellipse is $\pi(\text{Length})(\text{Width}) \div 4 = .36 \text{ In.}^2$

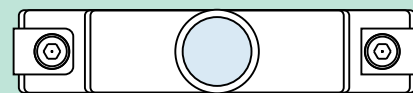

Round Cable Entry

100 Pin .375 Inch (9.5 mm.) Diameter



Elliptical Cable Entry

100 Pin .360 By 1.29 Inch (9.1 X 32.8 mm.)

BAND-IT® SHIELD TERMINATION SYSTEM

Fast, Cost-Effective Shield Termination

Attach cable braid shields to EMI backshells with **BAND-IT®** stainless steel straps. The **BAND-IT®** system offers fast termination and the flexibility to handle different diameters with the same band.

The aerospace industry has adopted this system for every type of application where reliability and durability are essential.

IMPORTANT NOTE: ALWAYS DOUBLE-WRAP BANDS!

Contact Glenair or visit our website (www.glenair.com) to view our complete line of **BAND-IT®** products, including pneumatic tools for high production and calibration kits.

Micro Band Tool

Part Number **600-061**
Weight: 1.18 lbs.
Length: 6.75 Inches (172mm.)



Standard Length Micro Band

8.125 Inches (206 mm.)
Part Number **600-057**
600-057-1 Pre-Coiled
Up to .88 Inches (22 mm.) Diameter

Extended Length Micro Band

14.25 Inches (362 mm.)
Part Number **600-083**
600-083-1 Pre-Coiled
Up to 1.88 Inches (47 mm) Diameter

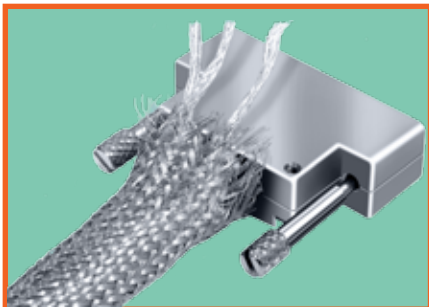

Step One Cable Prep

Lay individual shields over the band platform. Pull overall braid shield over the band platform so that all braid strands will be captured by the band.



Step Two Install Band

Wrap the band through the buckle twice. Insert the free end into the banding tool in the direction shown on the tool. Squeeze the short grey handle to insert the band. Slide the band onto the cable. Close the black handle repeatedly until the handle no longer opens. Close the long grey handle until the tool cuts the band. Remove the excess strap from the tool by closing the small grey handle.

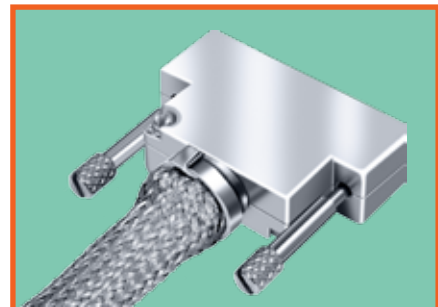

Step Three Trim Braid

It's a snap! Just trim the excess braid and you're done.

Micro-D Backshells General Information and Reference Data



ROUND CABLE ENTRY DIAMETER AND WIRE BUNDLE SIZE

Micro-D backshells have a cable entry code in the part number. This code determines the inside diameter of the wire opening.

CABLE ENTRY CODES

Code	Inside Diameter
04	.125
05	.156
06	.188
07	.219
08	.250
09	.281
10	.312
11	.344
12	.375

Round Cable Entry Backshells May Not Be Large Enough to Accomodate Standard Micro-D Wire Bundles

Backshells with round cable entry might not have enough room for the connector wires. Refer to the table below to find out if the wire bundle exceeds the available backshell cable entry size. These are general guidelines. Twisted wires, tubing or other factors can increase the bundle diameter.

Elliptical backshells are recommended for large bundles.



Round Cable Entry



Elliptical Cable Entry
Area = $\pi(\text{Length})(\text{Width}) \div 4$

STANDARD MICRO-D WIRE BUNDLE DIAMETERS

No. of Wires	M22759/11 Wire Bundle Diameter						M22759/33 Wire Bundle Diameter					
	#24 AWG	Entry Code	#26 AWG	Entry Code	#28 AWG	Entry Code	#24 AWG	Entry Code	#26 AWG	Entry Code	#28 AWG	Entry Code
9	.155	06	.138	07	.121	05	.135	05	.117	05	.100	04
15	.200	07	.178	07	.156	06	.174	06	.151	06	.129	05
21	.237	08	.211	08	.184	07	.206	07	.179	07	.153	06
25	.259	09	.230	09	.201	07	.224	08	.196	07	.167	06
31	.288	10	.256	09	.224	08	.250	09	.218	08	.186	07
37	.315	11 ⁽¹⁾	.280	10 ⁽¹⁾	.245	08	.273	09	.238	08	.203	07
51	.370	— ⁽²⁾	.329	11 ⁽¹⁾	.287	10	.320	11 ⁽¹⁾	.279	09	.238	08
67	.424	— ⁽²⁾	.377	— ⁽²⁾	.329	11 ⁽¹⁾	.367	12 ⁽¹⁾	.320	11 ⁽¹⁾	.273	09
69	.430	— ⁽²⁾	.382	— ⁽²⁾	.334	11 ⁽¹⁾	.373	— ⁽²⁾	.325	11 ⁽¹⁾	.277	10
100	.518	— ⁽²⁾	.460	— ⁽²⁾	.403	— ⁽²⁾	.441	— ⁽²⁾	.384	— ⁽²⁾	.328	11 ⁽¹⁾

(1) Wire bundle diameter exceeds the largest cable entry for top and 45° entry. Side entry is OK.

(2) Wire bundle exceeds maximum cable entry. Use elliptical versions.

FINISH OPTIONS

Finish Code	Description	Specification	Corresponding Connector Finish Code
C	Black Anodize	MIL-A-8625 Type II Class 2	Code 4
E	Chem Film	MIL-C-5541 Class 3	Code 6
J	Cadmium Plate Over Electroless Nickel with Yellow Chromate Conversion Coating	SAE-AMS-QQ-P-416 Type II Class 3	Code 1
M	Electroless Nickel	SAE-AMS-26074 Class 3	Code 2
NF	Olive Drab Cadmium Plate Over Electroless Nickel (1000 Hour Corrosion Rated)	SAE-AMS-QQ-P-416	NF (Special order)
XM	Electroless Nickel (Composite Only)	SAE-AMS-26074 Class 3	Code 2
Z2	Gold Plated	ASTM B488	Code 5

MATERIALS

Shell, Saddle Clamps	Aluminum Alloy 6061 -T6 Per QQ-A-200, QQ-A-225 (Machined Components) Aluminum Alloy 6061-T6 Per QQ-A-591 (A380) (Die-Cast Components)
Clips, E-Rings	17-7PH Stainless Steel
Jackscrows, Washers, Jackposts	300 Series Stainless Steel, Passivated



EMI/RFI Micro-D Banding Backshell and Round Cable Entry 500-010





Glenair's Most Popular Micro-D Backshell is stocked in all sizes. Choose straight, side or 45° cable entry.

Rugged One-Piece Aluminum shell with stainless steel hardware, available in standard nickel plating, or choose optional finishes.

17-7PH Stainless Steel Clips attach the backshell to the connector. These backshells accept standard and micro **BAND-IT®** shield termination straps.

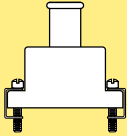
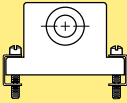
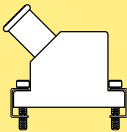
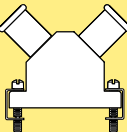
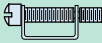
HOW TO ORDER 500-010 EMI BACKSHELLS

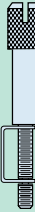
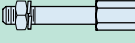
Series	Shell Finish	Connector Size	Hardware Option	Cable Entry Code	EMI Band Strap Option																																																																	
Top Entry 500T010  Side Entry 500S010  45° Entry 500E010  Dual 45° 500D010 	E – Chem Film (Alodyne) J – Cadmium, Yellow Chromate M – Electroless Nickel NF – Cadmium, Olive Drab Z2 – Gold	09 15 21 25 31 37 51 51-2 67 69 100	B – Fillister Head Jackscrew  H – Hex Head Jackscrew  E – Extended Jackscrew (Not for 45° Entry)  F – Jackpost, Female 	04 – .125 (3.2) 05 – .156 (4.0) 06 – .188 (4.8) 07 – .219 (5.6) 08 – .250 (6.4) 09 – .281 (7.1) 10 – .312 (7.9) 11 – .344 (8.7) 12 – .375 (9.5)	Omit (Leave Blank) Band Not Included Use the following codes if you want the band strap included with the connector. For best availability, order band separately. Standard Band .250" Wide B – Uncoiled Band Included K – Coiled Band Included Micro Band .125" Wide M – Uncoiled Band Included L – Coiled Band Included																																																																	
	<table border="1"> <thead> <tr> <th rowspan="2">Maximum Cable Entry Code</th> <th colspan="4">Size</th> </tr> <tr> <th>T Entry</th> <th>E 45° Entry</th> <th>S Side Entry</th> <th>D Dual 45°</th> </tr> </thead> <tbody> <tr><td>09</td><td>08</td><td>08</td><td>09</td><td>06</td></tr> <tr><td>15</td><td>08</td><td>08</td><td>12</td><td>08</td></tr> <tr><td>21</td><td>08</td><td>08</td><td>12</td><td>08</td></tr> <tr><td>25</td><td>08</td><td>08</td><td>12</td><td>08</td></tr> <tr><td>31</td><td>09</td><td>09</td><td>12</td><td>09</td></tr> <tr><td>37</td><td>09</td><td>09</td><td>12</td><td>09</td></tr> <tr><td>51</td><td>10</td><td>10</td><td>12</td><td>10</td></tr> <tr><td>51-2</td><td>09</td><td>09</td><td>12</td><td>09</td></tr> <tr><td>67</td><td>09</td><td>09</td><td>12</td><td>09</td></tr> <tr><td>69</td><td>10</td><td>10</td><td>12</td><td>10</td></tr> <tr><td>100</td><td>12</td><td>12</td><td>12</td><td>12</td></tr> </tbody> </table>						Maximum Cable Entry Code	Size				T Entry	E 45° Entry	S Side Entry	D Dual 45°	09	08	08	09	06	15	08	08	12	08	21	08	08	12	08	25	08	08	12	08	31	09	09	12	09	37	09	09	12	09	51	10	10	12	10	51-2	09	09	12	09	67	09	09	12	09	69	10	10	12	10	100	12	12	12	12
	Maximum Cable Entry Code	Size																																																																				
		T Entry	E 45° Entry	S Side Entry	D Dual 45°																																																																	
	09	08	08	09	06																																																																	
	15	08	08	12	08																																																																	
	21	08	08	12	08																																																																	
	25	08	08	12	08																																																																	
	31	09	09	12	09																																																																	
	37	09	09	12	09																																																																	
51	10	10	12	10																																																																		
51-2	09	09	12	09																																																																		
67	09	09	12	09																																																																		
69	10	10	12	10																																																																		
100	12	12	12	12																																																																		
Sample Part Number																																																																						
500T010	M	25	H	08																																																																		

EMI/RFI Micro-D Banding Backshell and Round Cable Entry

500-010



MATERIALS (SEE ORDERING INFO FOR FINISH OPTIONS)

Shell	Aluminum Alloy 6061 -T6 Per QQ-A-200, QQ-A-225 (Machined Components) Aluminum Alloy 6061-T6 Per QQ-A-591 (A380) (Die-Cast Components)
Clips, E-Rings	17-7PH Stainless Steel
Jackscrows, Washers, Jackposts	300 Series Stainless Steel, Passivated

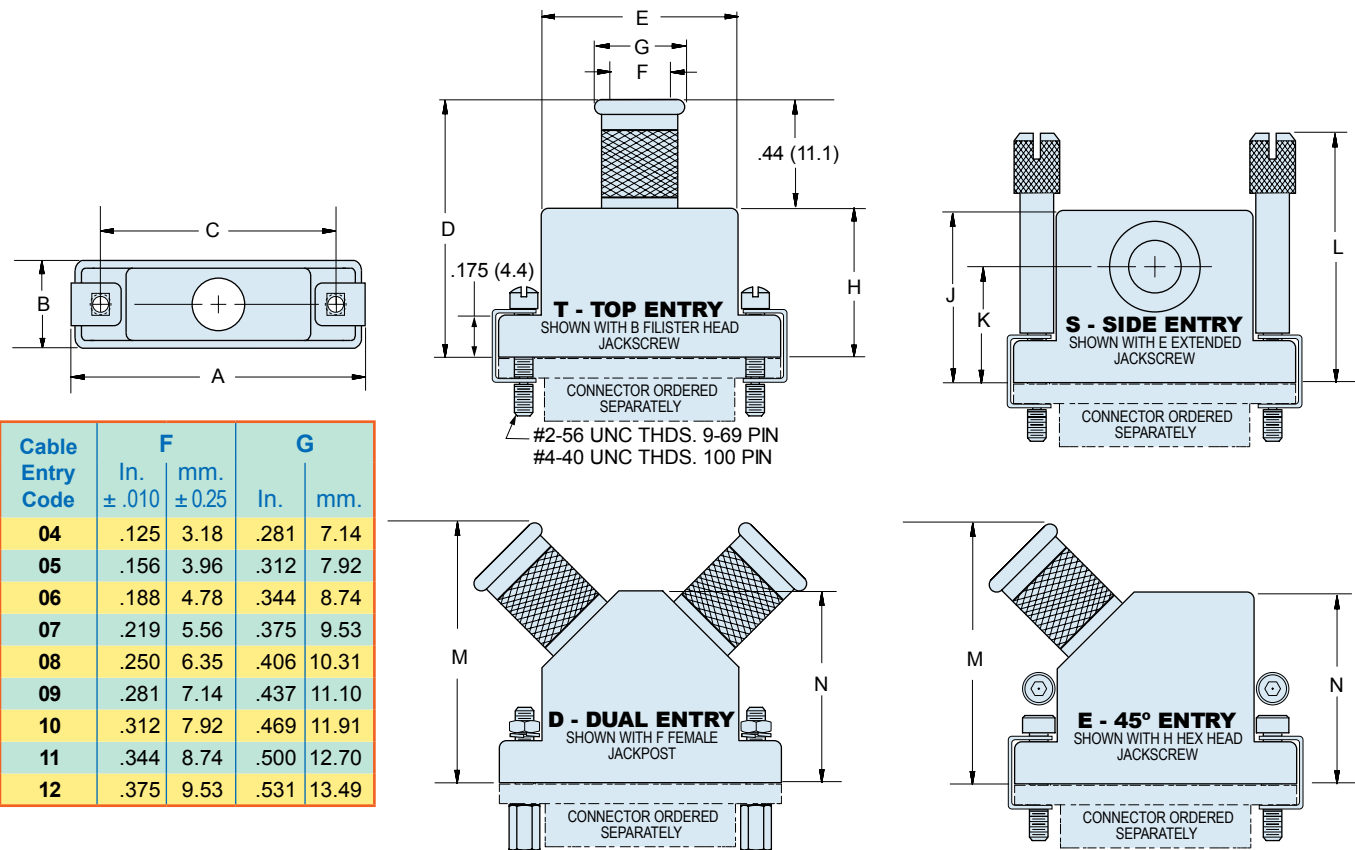

Cable Entry Code	F		G	
	In. ±.010	mm. ±0.25	In.	mm.
04	.125	3.18	.281	7.14
05	.156	3.96	.312	7.92
06	.188	4.78	.344	8.74
07	.219	5.56	.375	9.53
08	.250	6.35	.406	10.31
09	.281	7.14	.437	11.10
10	.312	7.92	.469	11.91
11	.344	8.74	.500	12.70
12	.375	9.53	.531	13.49

DIMENSIONS

Size	A Max.		B Max.		C		D Max.		E Max.		H Max.		J Max.		K		L Max.		M Max.		N Max.	
	In.	mm.	In.	mm.	In.	mm.	In.	mm.	In.	mm.	In.	mm.	In.	mm.	In.	mm.	In.	mm.	In.	mm.	In.	mm.
09	.850	21.59	.370	9.40	.565	14.35	.780	19.81	.410	10.41	.350	8.89	.637	16.18	.435	11.05	1.040	26.42	1.000	25.40	.680	17.27
15	1.000	25.40	.370	9.40	.715	18.16	.910	23.11	.580	14.73	.470	11.94	.673	17.09	.440	11.2	1.170	29.72	1.030	26.16	.730	18.54
21	1.150	29.21	.370	9.40	.865	21.97	1.030	26.16	.740	18.80	.590	14.99	.707	17.95	.458	11.63	1.290	32.77	1.050	26.67	.765	19.43
25	1.250	31.75	.370	9.40	.965	24.51	1.090	27.69	.850	21.59	.650	16.51	.748	19.00	.483	12.27	1.350	34.29	1.090	27.69	.830	21.08
31	1.400	35.56	.370	9.40	1.115	28.32	1.150	29.21	.980	24.89	.710	18.03	.756	19.20	.476	12.09	1.420	36.07	1.130	28.70	.890	22.61
37	1.550	39.37	.370	9.40	1.265	32.13	1.190	30.23	1.130	28.70	.750	19.05	.774	19.66	.478	12.14	1.450	36.83	1.230	31.24	.955	24.26
51	1.500	38.10	.410	10.41	1.215	30.86	1.220	30.99	1.080	27.43	.780	19.81	.859	21.82	.548	13.91	1.480	37.59	1.250	31.75	1.005	25.53
51-2	1.910	48.51	.370	9.40	1.615	41.02	1.220	30.99	1.510	38.35	.780	19.81	.859	21.82	.548	13.91	1.480	37.59	1.250	31.75	1.005	25.53
67	2.310	58.67	.370	9.40	2.015	51.18	1.220	30.99	1.880	47.75	.780	19.81	.859	21.82	.548	13.91	1.480	37.59	1.250	31.75	1.005	25.53
69	1.810	45.97	.410	10.41	1.515	38.48	1.220	30.99	1.380	35.05	.780	19.81	.859	21.82	.548	13.91	1.480	37.59	1.250	31.75	1.005	25.53
100	2.235	56.77	.460	11.68	1.800	45.72	1.280	32.51	1.470	37.34	.840	21.34	1.014	25.76	.687	17.45	1.580	40.13	1.320	33.53	1.080	27.43



EMI/RFI Shield Sock Backshell with Round Cable Entry 500-011



Shield Sock Backshells save assembly time. These backshells are terminated to tinned copper braid in whatever length you require.

Available in Top, 45° and Side Entry, these backshells feature one piece construction and are available in a variety of plating finishes.

Precision Swaged Braid Termination adds mechanical strength and lowers resistance compared to hex crimps.

HOW TO ORDER 500-011 SHIELD SOCK EMI BACKSHELLS

Series	Shell Finish	Connector Size	Hardware Option	Cable Entry Code	Length of Braid																																																				
<p>Top Entry 500T011</p> <p>Side Entry 500S011</p> <p>45° Entry 500E011</p>	<p>E – Chem Film (Alodyne)</p> <p>J – Cadmium, Yellow Chromate</p> <p>M – Electroless Nickel</p> <p>NF – Cadmium, Olive Drab</p> <p>Z2 – Gold</p>	<p>09</p> <p>15</p> <p>21</p> <p>25</p> <p>31</p> <p>37</p> <p>51</p> <p>51-2</p> <p>67</p> <p>69</p> <p>100</p>	<p>B – Fillister Head Jackscrew</p> <p>H – Hex Head Jackscrew</p> <p>E – Extended Jackscrew</p> <p>(Not for 45° Entry)</p> <p>F – Jackpost, Female</p>	<p>04 – .125 (3.2)</p> <p>05 – .156 (4.0)</p> <p>06 – .188 (4.8)</p> <p>07 – .219 (5.6)</p> <p>08 – .250 (6.4)</p> <p>09 – .281 (7.1)</p> <p>10 – .312 (7.9)</p> <p>11 – .344 (8.7)</p> <p>12 – .375 (9.5)</p>	<p>Length in One Inch Increments</p> <p>Example: "6" equals six inches.</p>																																																				
				<table border="1" style="margin: auto; border-collapse: collapse;"> <thead> <tr> <th colspan="4" style="text-align: center; background-color: #fff9c4;">Maximum Cable Entry Code</th> </tr> <tr> <th style="text-align: center;">Size</th> <th style="text-align: center;">T Top Entry</th> <th style="text-align: center;">E 45° Entry</th> <th style="text-align: center;">S Side Entry</th> </tr> </thead> <tbody> <tr><td style="text-align: center;">9</td><td style="text-align: center;">08</td><td style="text-align: center;">08</td><td style="text-align: center;">09</td></tr> <tr><td style="text-align: center;">15</td><td style="text-align: center;">08</td><td style="text-align: center;">08</td><td style="text-align: center;">12</td></tr> <tr><td style="text-align: center;">21</td><td style="text-align: center;">08</td><td style="text-align: center;">08</td><td style="text-align: center;">12</td></tr> <tr><td style="text-align: center;">25</td><td style="text-align: center;">08</td><td style="text-align: center;">08</td><td style="text-align: center;">12</td></tr> <tr><td style="text-align: center;">31</td><td style="text-align: center;">09</td><td style="text-align: center;">09</td><td style="text-align: center;">12</td></tr> <tr><td style="text-align: center;">37</td><td style="text-align: center;">09</td><td style="text-align: center;">09</td><td style="text-align: center;">12</td></tr> <tr><td style="text-align: center;">51</td><td style="text-align: center;">10</td><td style="text-align: center;">10</td><td style="text-align: center;">12</td></tr> <tr><td style="text-align: center;">51-2</td><td style="text-align: center;">09</td><td style="text-align: center;">09</td><td style="text-align: center;">12</td></tr> <tr><td style="text-align: center;">67</td><td style="text-align: center;">09</td><td style="text-align: center;">09</td><td style="text-align: center;">12</td></tr> <tr><td style="text-align: center;">69</td><td style="text-align: center;">10</td><td style="text-align: center;">10</td><td style="text-align: center;">12</td></tr> <tr><td style="text-align: center;">100</td><td style="text-align: center;">12</td><td style="text-align: center;">12</td><td style="text-align: center;">12</td></tr> </tbody> </table>	Maximum Cable Entry Code				Size	T Top Entry	E 45° Entry	S Side Entry	9	08	08	09	15	08	08	12	21	08	08	12	25	08	08	12	31	09	09	12	37	09	09	12	51	10	10	12	51-2	09	09	12	67	09	09	12	69	10	10	12	100	12	12	12	
Maximum Cable Entry Code																																																									
Size	T Top Entry	E 45° Entry	S Side Entry																																																						
9	08	08	09																																																						
15	08	08	12																																																						
21	08	08	12																																																						
25	08	08	12																																																						
31	09	09	12																																																						
37	09	09	12																																																						
51	10	10	12																																																						
51-2	09	09	12																																																						
67	09	09	12																																																						
69	10	10	12																																																						
100	12	12	12																																																						
Sample Part Number																																																									
500T011	M	25	H	08	— 12																																																				

EMI/RFI Shield Sock Backshell with Round Cable Entry

500-011



MATERIALS (SEE ORDERING INFO FOR FINISH OPTIONS)

Shell	Aluminum Alloy 6061 -T6 Per QQ-A-200, QQ-A-225 (Machined Components) Aluminum Alloy 6061-T6 Per QQ-A-591 (A380) (Die-Cast Components)
Braid	Tinned Copper Braid Per QQ-B-575 ASTM B33, #36 AWG Strands, 90% Coverage
Crimp Ring	Copper, Tin Plated
Clips, E-Rings	17-7PH Stainless Steel
Jackscrews, Washers, Jackposts	300 Series Stainless Steel, Passivated

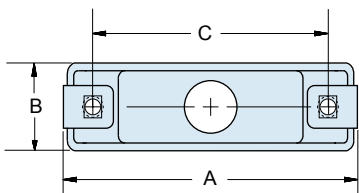

Cable Entry Code	F		G Max.	
	In. ± .010	mm. ± 0.25	In.	mm.
04	.125	3.18	.310	7.87
05	.156	3.96	.350	8.89
06	.188	4.78	.380	9.65
07	.219	5.56	.400	10.16
08	.250	6.35	.425	13.31
09	.281	7.14	.450	11.43
10	.312	7.92	.500	12.70
11	.344	8.74	.525	13.34
12	.375	9.53	.550	13.97

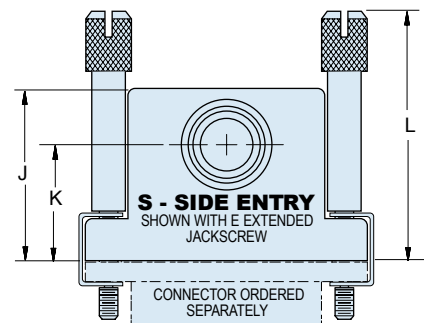
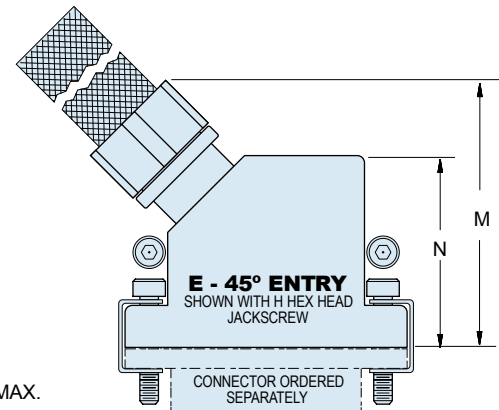
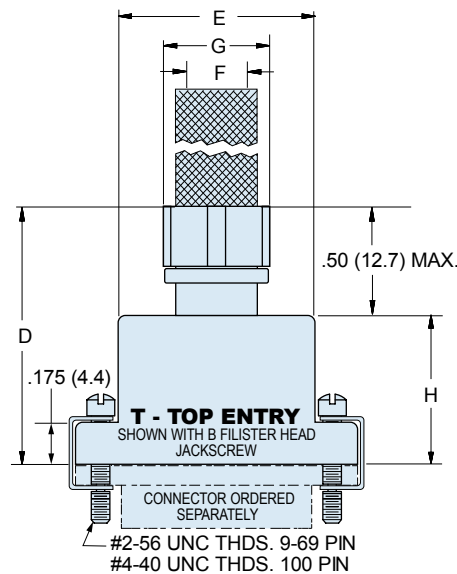

SHIELD SOCK BACKSHELL DIMENSIONS – 500-011

Size	A Max.		B Max.		C		D Max.		E Max.		H Max.		J Max.		K		L Max.		M Max.		N Max.	
	In.	mm.	In.	mm.	In.	mm.	In.	mm.	In.	mm.	In.	mm.	In.	mm.	In.	mm.	In.	mm.	In.	mm.	In.	mm.
09	.850	21.59	.370	9.40	.565	14.35	.780	19.81	.410	10.41	.350	8.89	.637	16.18	.435	11.05	1.040	26.42	1.000	25.40	.680	17.27
15	1.000	25.40	.370	9.40	.715	18.16	.910	23.11	.580	14.73	.470	11.94	.673	17.09	.440	11.20	1.170	29.72	1.030	26.16	.730	18.54
21	1.150	29.21	.370	9.40	.865	21.97	1.030	26.16	.740	18.80	.590	14.99	.707	17.95	.458	11.63	1.290	32.77	1.050	26.67	.765	19.43
25	1.250	31.75	.370	9.40	.965	24.51	1.090	27.69	.850	21.59	.650	16.51	.748	19.00	.483	12.27	1.350	34.29	1.090	27.69	.830	21.08
31	1.400	35.56	.370	9.40	1.115	28.32	1.150	29.21	.980	24.89	.710	18.03	.756	19.20	.476	12.09	1.420	36.07	1.130	28.70	.890	22.61
37	1.550	39.37	.370	9.40	1.265	32.13	1.190	30.23	1.130	28.70	.750	19.05	.774	19.66	.478	12.14	1.450	36.83	1.230	31.24	.955	24.26
51	1.500	38.10	.410	10.41	1.215	30.86	1.220	30.99	1.080	27.43	.780	19.81	.859	21.82	.548	13.91	1.480	37.59	1.250	31.75	1.005	25.53
51-2	1.910	48.51	.370	9.40	1.615	41.02	1.220	30.99	1.510	38.35	.780	19.81	.859	21.82	.548	13.91	1.480	37.59	1.250	31.75	1.005	25.53
67	2.310	58.67	.370	9.40	2.015	51.18	1.220	30.99	1.880	47.75	.780	19.81	.859	21.82	.548	13.91	1.480	37.59	1.250	31.75	1.005	25.53
69	1.810	45.97	.410	10.41	1.515	38.48	1.220	30.99	1.380	35.05	.780	19.81	.859	21.82	.548	13.91	1.480	37.59	1.250	31.75	1.005	25.53
100	2.235	56.77	.460	11.68	1.800	45.72	1.280	32.51	1.470	37.34	.840	21.34	1.014	25.76	.687	17.45	1.580	40.13	1.320	33.53	1.080	27.43



Qwik-Ty Strain Relief Backshell 500-012



Qwik-Ty Backshell is stocked in all sizes. Choose "M" Nickel Finish and "T" top entry for best availability. Customer-furnished cable ties provide strain relief to wire bundles. Suitable for jacketed cable or use with individual wires.

MATERIALS

Shell	Aluminum Alloy 6061 -T6
Clips	17-7PH Stainless Steel
Hardware	300 Series Stainless Steel

HOW TO ORDER 500-012 QWIK-TY STRAIN RELIEF BACKSHELLS

Series	Shell Finish	Connector Size	Hardware Option
Top Entry 500T012	E – Chem Film (Alodyne) J – Cadmium, Yellow Chromate	09 15	B – Fillister Head Jackscrew H – Hex Head Jackscrew
Side Entry 500S012	M – Electroless Nickel NF – Cadmium, Olive Drab	21 25	E – Extended Jackscrew F – Jackpost, Female
45° Entry 500E012	Z2 – Gold	31 37	
Sample Part Number			
500T012	M	25	H

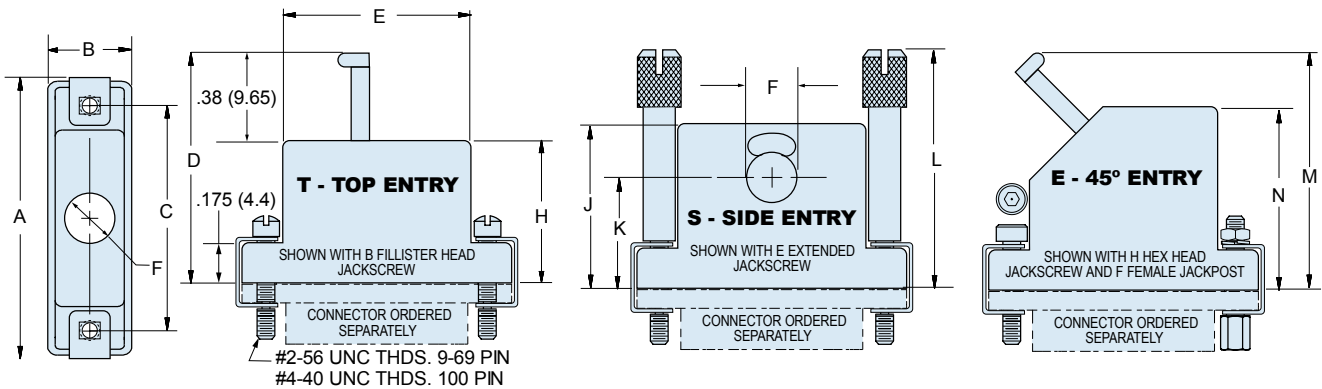

Size	A Max.		B Max.		C		D Max.		E Max.		F		H Max.		J Max.		K		L Max.		M Max.		N Max.	
	In.	mm.	In.	mm.	In.	mm.	In.	mm.	In.	mm.	In.	mm.	In.	mm.	In.	mm.	In.	mm.	In.	mm.	In.	mm.	In.	mm.
09	.850	21.59	.370	9.40	.565	14.35	.780	19.81	.410	10.41	.156	3.18	.350	8.89	.637	16.18	.435	11.05	1.040	26.42	1.000	25.40	.680	17.27
15	1.000	25.40	.370	9.40	.715	18.16	.910	23.11	.580	14.73	.188	3.96	.470	11.94	.673	17.09	.440	11.20	1.170	29.72	1.030	26.16	.730	18.54
21	1.150	29.21	.370	9.40	.865	21.97	1.030	26.16	.740	18.80	.219	4.78	.590	14.99	.707	17.95	.458	11.63	1.290	32.77	1.050	26.67	.765	19.43
25	1.250	31.75	.370	9.40	.965	24.51	1.090	27.69	.850	21.59	.250	5.56	.650	16.51	.748	19.00	.483	12.27	1.350	34.29	1.090	27.69	.830	21.08
31	1.400	35.56	.370	9.40	1.115	28.32	1.150	29.21	.980	24.89	.265	6.35	.710	18.03	.756	19.20	.476	12.09	1.420	36.07	1.130	28.70	.890	22.61
37	1.550	39.37	.370	9.40	1.265	32.13	1.190	30.23	1.130	28.70	.281	7.14	.750	19.05	.774	19.66	.478	12.14	1.450	36.83	1.230	31.24	.955	24.26
51	1.500	38.10	.410	10.41	1.215	30.86	1.220	30.99	1.080	27.43	.312	7.92	.780	19.81	.859	21.82	.548	13.91	1.480	37.59	1.250	31.75	1.005	25.53
51-2	1.910	48.51	.370	9.40	1.615	41.02	1.220	30.99	1.510	38.35	.281	7.14	.780	19.81	.859	21.82	.548	13.91	1.480	37.59	1.250	31.75	1.005	25.53
67	2.310	58.67	.370	9.40	2.015	51.18	1.220	30.99	1.880	47.75	.281	7.14	.780	19.81	.859	21.82	.548	13.91	1.480	37.59	1.250	31.75	1.005	25.53
69	1.810	45.97	.410	10.41	1.515	38.48	1.220	30.99	1.380	47.75	.312	7.92	.780	19.81	.859	21.82	.548	13.91	1.480	37.59	1.250	31.75	1.005	25.53
100	2.235	56.77	.460	11.68	1.800	45.72	1.280	32.51	1.470	37.34	.375	9.53	.840	21.34	1.014	25.76	.687	17.45	1.580	40.13	1.320	33.53	1.080	27.43

M

Shorting Can 500-016



Micro-D
Backshells



Shorting Backshells are closed shells used to provide a convenient way to protect Micro-D connectors used for circuit switching or shorting. Lanyards provide easy attachment to chassis panels.

MATERIALS

Shell	Aluminum Alloy 6061 -T6
Clips	17-7PH Stainless Steel
Hardware	300 Series Stainless Steel

HOW TO ORDER 500-016 SHORTING BACKSHELLS

Series	Shell Finish	Connector Size	Hardware Option	Lanyard Option	Lanyard Length	Ring Terminal Ordering Code
500-016	E – Chem Film	09 51	B – Fillister Head Jackscrew	N – No Lanyard	Length in One Inch Increments Example: "6" equals six inches.	06 – .125 (3.2)
	J – Cadmium, Yellow Chromate	15 51-2				01 – .140 (3.6)
	M – Electroless Nickel	21 67	H – Hex Head Jackscrew	F – Wire Rope, Nylon Jacket		05 – .167 (4.2)
	NF – Cadmium, Olive Drab	25 69				04 – .197 (5.0)
	31 100	E – Extended Jackscrew	H – Wire Rope, Teflon Jacket	I.D. of Ring Terminal		
	37			F – Jackpost, Female		
Sample Part Number						
500-016	M	25	H	F	4	- 06

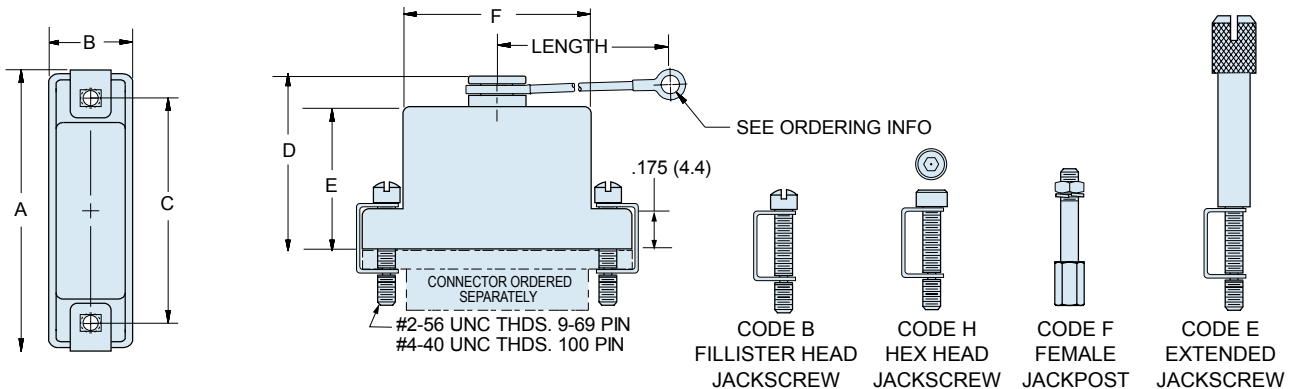

Size	A Max.		B Max.		C		D Max.		E Max.		F Max.	
	In.	mm.	In.	mm.	In.	mm.	In.	mm.	In.	mm.	In.	mm.
09	.850	21.59	.370	9.40	.565	14.35	.500	12.70	.350	8.89	.410	10.41
15	1.000	25.40	.370	9.40	.715	18.16	.620	15.75	.470	11.94	.580	14.73
21	1.150	29.21	.370	9.40	.865	21.97	.740	18.80	.590	14.99	.740	18.80
25	1.250	31.75	.370	9.40	.965	24.51	.800	20.32	.650	16.51	.850	21.59
31	1.400	35.56	.370	9.40	1.115	28.32	.860	21.84	.710	18.03	.980	24.89
37	1.550	39.37	.370	9.40	1.265	32.13	.900	22.86	.750	19.05	1.130	28.70
51	1.500	38.10	.410	10.41	1.215	30.86	.930	23.62	.780	19.81	1.080	27.43
51-2	1.910	48.51	.370	9.40	1.615	41.02	.930	23.62	.780	19.81	1.510	38.35
67	2.310	58.67	.370	9.40	2.015	51.18	.930	23.62	.780	19.81	1.880	47.75
69	1.810	45.97	.410	10.41	1.515	38.48	.930	23.62	.780	19.81	1.380	35.05
100	2.235	56.77	.460	11.68	1.800	45.72	.990	25.15	.840	21.34	1.470	37.34





EMI/RFI Elliptical Banding Backshell 500-047



Elliptical Backshells provide extra room for large wire bundles. This one piece version features an oversize shield termination area for both standard and micro **BAND-IT®** shield termination straps.

MATERIALS

Shell	Aluminum Alloy 6061 -T6
Clips	17-7PH Stainless Steel
Hardware	300 Series Stainless Steel

HOW TO ORDER 500-047 ELLIPTICAL BACKSHELLS

Series	Shell Finish	Connector Size		Hardware Option	EMI Band Strap Option
500-047	E – Chem Film	09	51	B – Fillister Head Jackscrew	Omit (Leave Blank) Band Not Included
	J – Cadmium, Yellow Chromate	15	51-2		
	M – Electroless Nickel	21	67	H – Hex Head Jackscrew	
	NF – Cadmium, Olive Drab	25	69		
	31	100	E – Extended Jackscrew	F – Jackpost, Female	
	37				M – Micro Band .125" Wide

Sample Part Number

500-047	M	25	H
----------------	----------	-----------	----------

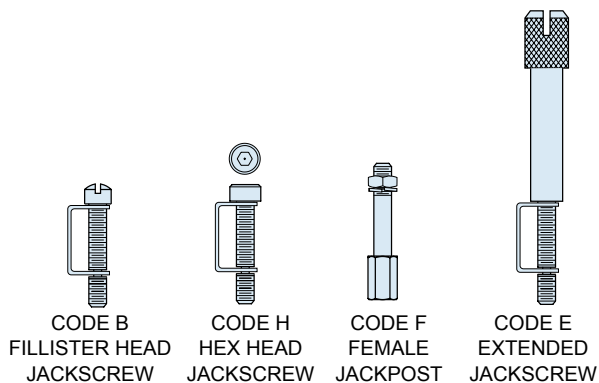
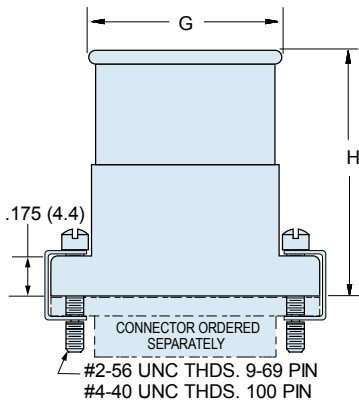
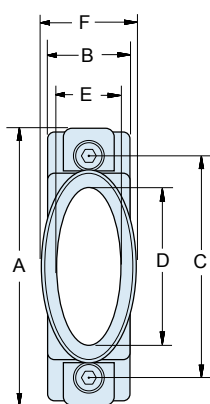

Size	A Max.		B Max.		C		D Max.		E		F Max.		G Max.		H Max.	
	In.	mm.	In.	mm.	In.	mm.	In.	mm.	In.	mm.	In.	mm.	In.	mm.	In.	mm.
09	.850	21.59	.370	9.40	.565	14.35	.312	7.92	.281	7.14	.450	11.43	.481	12.22	.780	19.81
15	1.000	25.40	.370	9.40	.715	18.16	.420	10.67	.281	7.14	.450	11.43	.589	14.96	.910	23.11
21	1.150	29.21	.370	9.40	.865	21.97	.591	15.01	.281	7.14	.450	11.43	.759	19.28	1.030	26.16
25	1.250	31.75	.370	9.40	.965	24.51	.690	17.53	.281	7.14	.450	11.43	.859	21.82	1.090	27.68
31	1.400	35.56	.370	9.40	1.115	28.32	.820	20.83	.281	7.14	.450	11.43	.989	25.12	1.150	29.21
37	1.550	39.37	.370	9.40	1.265	32.13	.970	24.64	.281	7.14	.450	11.43	1.139	28.93	1.180	29.97
51	1.500	38.10	.410	10.41	1.215	30.86	.920	23.37	.312	7.92	.481	12.22	1.089	27.66	1.220	30.99
51-2	1.910	48.51	.370	9.40	1.615	41.02	1.030	26.16	.281	7.14	.450	11.43	1.489	37.82	1.220	30.99
67	2.310	58.67	.370	9.40	2.015	51.18	1.720	43.69	.281	7.14	.450	11.43	1.889	47.98	1.220	30.99
69	1.810	45.97	.410	10.41	1.515	38.48	1.220	30.99	.312	7.92	.481	12.22	1.389	35.28	1.220	30.99
100	2.235	56.77	.460	11.68	1.800	45.72	1.290	32.77	.360	9.14	.529	13.44	1.459	37.06	1.280	32.51

Potting Shell 507-035



Potting Shells provide easy encapsulation of Micro-D solder cup terminations. These potting shells provide .25 inches (6.3 mm.) of depth.

MATERIALS

Shell	Aluminum Alloy 6061 -T6
Clips	17-7PH Stainless Steel
Hardware	300 Series Stainless Steel

HOW TO ORDER 507-035 POTTING SHELLS

Series	Shell Finish	Connector Size	Hardware Option
507-035	E – Chem Film	09 51	Omit for Fillister Head Jackscrew H – Hex Head Jackscrew E – Extended Jackscrew F – Jackpost, Female
	J – Cadmium, Yellow Chromate	15 51-2	
	M – Electroless Nickel	21 67	
	NF – Cadmium, Olive Drab	25 69	
	Z2 – Gold	31 100 37	
Sample Part Number			
507-035	M	25	H

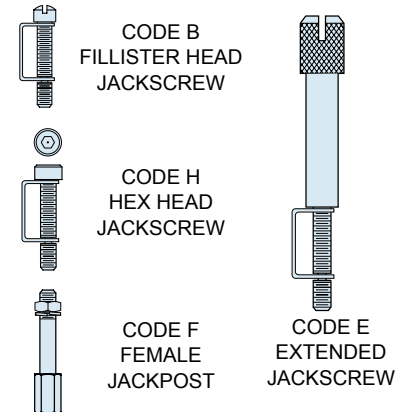
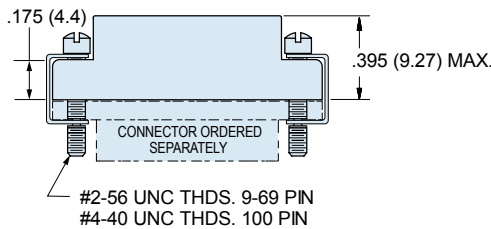
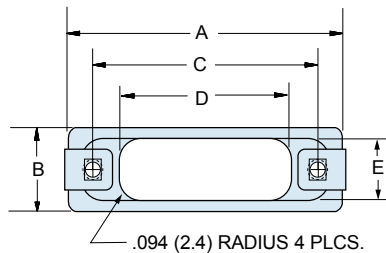

Size	A Max.		B Max.		C		D		E	
	In.	mm.	In.	mm.	In.	mm.	In. ± .030	mm. ± 0.8	In. ± .030	mm. ± 0.8
09	.850	21.59	.370	9.40	.565	14.35	.31	7.9	.26	6.6
15	1.000	25.40	.370	9.40	.715	18.16	.48	12.2	.26	6.6
21	1.150	29.21	.370	9.40	.865	21.97	.65	16.5	.26	6.6
25	1.250	31.75	.370	9.40	.965	24.51	.75	19.1	.26	6.6
31	1.400	35.56	.370	9.40	1.115	28.32	.88	22.4	.26	6.6
37	1.550	39.37	.370	9.40	1.265	32.13	1.03	26.2	.26	6.6
51	1.500	38.10	.410	10.41	1.215	30.86	.98	24.9	.30	7.6
51-2	1.910	48.51	.370	9.40	1.615	41.02	1.38	35.0	.26	6.6
67	2.310	58.67	.370	9.40	2.015	51.18	1.78	45.2	.26	6.6
69	1.810	45.97	.410	10.41	1.515	38.48	1.28	32.5	.30	7.6
100	2.235	56.77	.460	11.68	1.800	45.72	1.35	34.3	.36	9.1





Composite EMI/RFI Banding Backshell with Round Cable Entry 507-088



Save Weight and Eliminate Corrosion Damage with composite Micro-D backshells. These round cable entry backshells are injection-molded with high strength Ultem 2300 fiberglass-reinforced thermoplastic.



Choose Top, Side or 45° Cable Entry.

Electroless Nickel Plated for excellent EMI shielding effectiveness.

MATERIALS

Shell	Ultem 2300
Clips	17-7PH Stainless Steel
Hardware	300 Series Stainless Steel

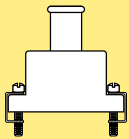
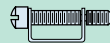
HOW TO ORDER 507-088 EMI BACKSHELLS

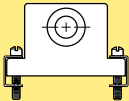
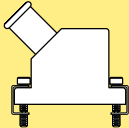
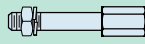
Series	Shell Finish	Connector Size	Hardware Option	Cable Entry Code
Top Entry 507T088 	XM Electroless Nickel	0 9 15 21 25 31 37 51 100	B – Fillister Head Jackscrew  H – Hex Head Jackscrew 	04 – .125 (3.2)
				05 – .156 (4.0)
				06 – .188 (4.8)
				07 – .219 (5.6)
				08 – .250 (6.4)
				09 – .281 (7.1)
				10 – .312 (7.9)
				11 – .344 (8.7)
				12 – .375 (9.5)
				Side Entry 507S088 
05 – .156 (4.0)				
06 – .188 (4.8)				
07 – .219 (5.6)				
08 – .250 (6.4)				
09 – .281 (7.1)				
10 – .312 (7.9)				
11 – .344 (8.7)				
12 – .375 (9.5)				
45° Entry 507E088 	XM Electroless Nickel	0 9 15 21 25 31 37 51 100	F – Jackpost, Female 	
				05 – .156 (4.0)
				06 – .188 (4.8)
				07 – .219 (5.6)
				08 – .250 (6.4)
				09 – .281 (7.1)
				10 – .312 (7.9)
				11 – .344 (8.7)
				12 – .375 (9.5)
				Sample Part Number
507T088	XM	25	H	08

Size	T Top Entry	E 45° Entry	S Side Entry
9	08	08	09
15	08	08	12
21	08	08	12
25	08	08	12
31	09	09	12
37	09	09	12
51	10	10	12
100	12	12	12

Composite EMI/RFI Banding Backshell with Round Cable Entry 507-088



Micro-D
Backshells

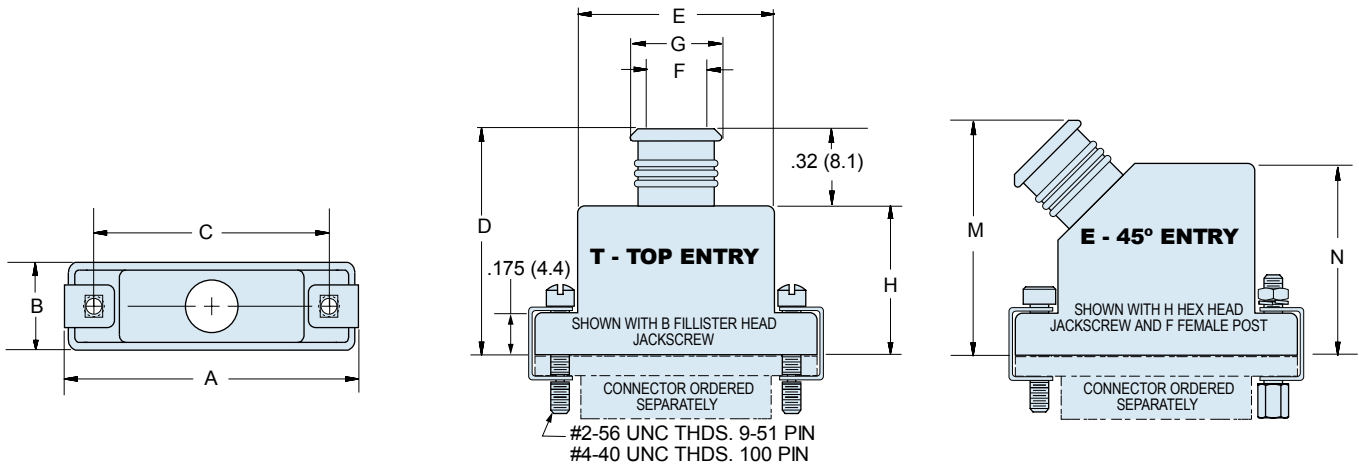

Cable Entry Code	F		G	
	In. ±.010	mm. ±0.25	In.	mm.
04	.125	3.18	.219	5.56
05	.156	3.96	.250	6.35
06	.188	4.78	.281	7.14
07	.219	5.56	.313	7.95
08	.250	6.35	.344	8.74
09	.281	7.14	.375	9.53
10	.312	7.92	.406	10.31
11	.344	8.74	.438	11.13
12	.375	9.53	.469	11.92

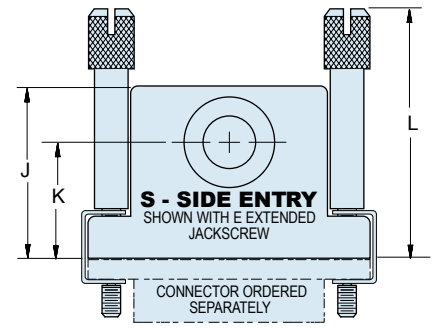

DIMENSIONS

Size	A Max.		B Max.		C		D Max.		E Max.		H Max.		J Max.		K		L Max.		M Max.		N Max.	
	In.	mm.	In.	mm.	In.	mm.	In.	mm.	In.	mm.	In.	mm.	In.	mm.	In.	mm.	In.	mm.	In.	mm.	In.	mm.
09	.850	21.59	.370	9.40	.565	14.35	.780	19.81	.410	10.41	.460	8.89	.680	17.27	.435	11.05	1.040	26.42	1.000	25.40	.680	17.27
15	1.000	25.40	.370	9.40	.715	18.16	.790	20.07	.580	14.73	.470	11.94	.730	18.54	.440	11.2	1.170	29.72	1.030	26.16	.730	18.54
21	1.150	29.21	.370	9.40	.865	21.97	.910	23.11	.740	18.80	.590	14.99	.765	19.43	.458	11.63	1.290	32.77	1.050	26.67	.765	19.43
25	1.250	31.75	.370	9.40	.965	24.51	.970	24.64	.850	21.59	.650	16.51	.830	21.08	.483	12.27	1.350	34.29	1.090	27.69	.830	21.08
31	1.400	35.56	.370	9.40	1.115	28.32	1.030	26.16	.980	24.89	.710	18.03	.890	20.32	.476	12.09	1.420	36.07	1.130	28.70	.890	22.61
37	1.550	39.37	.370	9.40	1.265	32.13	1.070	27.18	1.130	28.70	.750	19.05	.955	24.26	.478	12.14	1.450	36.83	1.230	31.24	.955	24.26
51	1.500	38.10	.410	10.41	1.215	30.86	1.100	27.94	1.080	27.43	.780	19.81	1.005	25.53	.548	13.91	1.480	37.59	1.250	31.75	1.005	25.53
100	2.235	56.77	.460	11.68	1.800	45.72	1.160	29.46	1.470	37.34	.810	21.34	1.080	27.43	.687	17.45	1.580	40.13	1.320	33.53	1.080	27.43





EMI/RFI Dual Entry Banding Backshell 507-142



Dual Cable Entry EMI backshell allows attachment of two separate wire bundles to the same Micro-D connector. This backshell accepts both standard and micro shield termination straps.

MATERIALS	
Shell	Aluminum Alloy 6061 -T6
Clips	17-7PH Stainless Steel
Hardware	300 Series Stainless Steel

HOW TO ORDER 507-142 DUAL ENTRY BACKSHELLS

Series	Shell Finish	Connector Size	Hardware Option	EMI Band Strap Option
507-142	E - Chem Film	09 51	B - Fillister Head Jackscrew	Omit (Leave Blank) Band Not Included
	J - Cadmium, Yellow Chromate	15 51-2		
	M - Electroless Nickel	21 67	H - Hex Head Jackscrew	
	NF - Cadmium, Olive Drab	25 69		
	Z2 - Gold	31 100		
		37	E - Extended Jackscrew	B - Standard Band (2 supplied) .250" Wide
			F - Jackpost, Female	M - Micro Band (2 supplied) .125" Wide
Sample Part Number				
507-142	M	25	H	

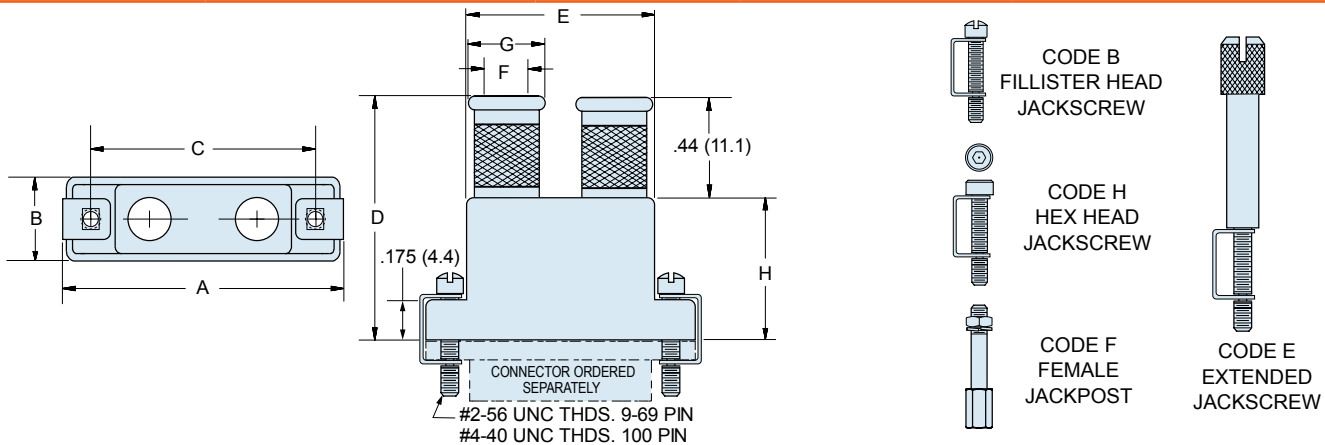

M

Size	A Max.		B Max.		C		D Max.		E Max.		F		G		H Max.	
	In.	mm.	In.	mm.	In.	mm.	In.	mm.	In.	mm.	In.	mm.	In.	mm.	In.	mm.
21	1.150	29.21	.370	9.40	.865	21.97	1.030	26.16	.740	18.80	.125	3.18	.281	7.13	.590	14.99
25	1.250	31.75	.370	9.40	.965	24.51	1.090	27.69	.850	21.59	.188	4.78	.344	8.74	.650	16.51
31	1.400	35.56	.370	9.40	1.115	28.32	1.150	29.21	.980	24.89	.250	6.35	.406	10.31	.710	18.03
37	1.550	39.37	.370	9.40	1.265	32.13	1.190	30.23	1.130	28.70	.344	8.74	.500	12.70	.750	19.05
51	1.500	38.10	.410	10.41	1.215	30.86	2.130	54.10	1.080	27.43	.312	7.92	.469	11.91	.780	19.81
51-2	1.910	48.51	.370	9.40	1.615	41.02	2.130	54.10	1.510	38.35	.281	7.13	.469	11.91	.780	19.81
67	2.310	58.67	.370	9.40	2.015	51.18	2.130	54.10	1.880	47.75	.281	7.13	.469	11.91	.780	19.81
69	1.810	45.97	.410	10.41	1.515	38.48	2.130	54.10	1.380	35.05	.312	7.93	.469	11.91	.780	19.81
100	2.235	56.77	.460	11.68	1.800	45.72	1.280	32.51	1.470	37.34	.500	12.70	.688	17.48	.840	21.34

EMI/RFI Split Shell Banding Backshell with Round Cable Entry 507-145



Split EMI Backshells allow installation on wired connector assemblies.

Captive Screwlocks for fast connection. Plug in the connector, then fasten the hardware.

MATERIALS

Shell	Aluminum Alloy 6061 -T6
Clips	17-7PH Stainless Steel
Hardware	300 Series Stainless Steel

HOW TO ORDER 507-145 SPLIT BACKSHELLS

Series	Shell Finish	Connector Size	Hardware Option	EMI Band Strap Option
507-145	E – Chem Film	09 51	Omit for Fillister Head Screwlock H – Hex Head Screwlock E – Extended Screwlock F – Jackpost, Female	Omit (Leave Blank) Band Not Included B – Micro Band Supplied K – Coiled Micro Band Supplied
	J – Cadmium, Yellow Chromate	15 51-2		
	M – Electroless Nickel	21 67		
	NF – Cadmium, Olive Drab	25 69		
	Z2 – Gold	31 100 37		
Sample Part Number				
507-145	M	25	H	

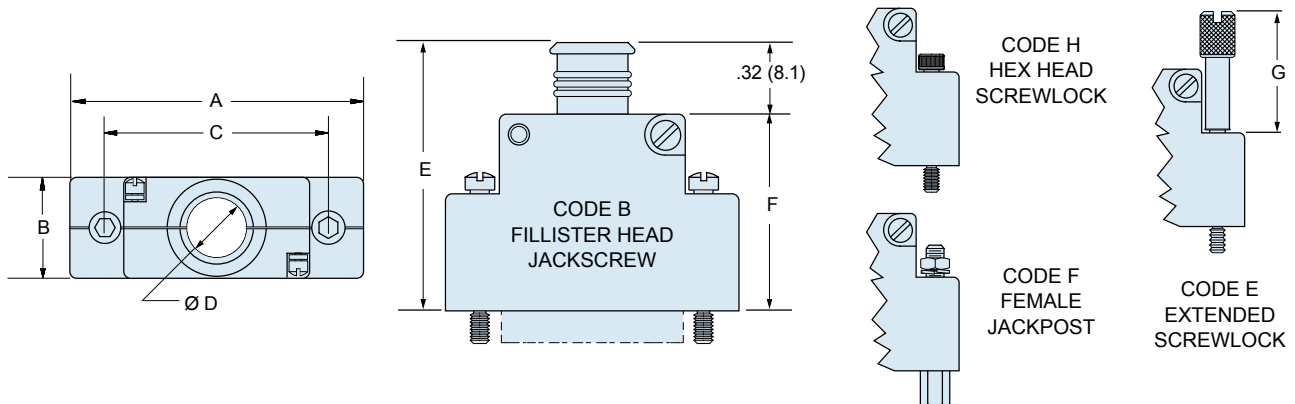

Size	A Max.		B Max.		C		D		E Max.		F Max.		G Max.	
	In.	mm.	In.	mm.	In.	mm.	In. ± .010	mm. ± 0.25	In.	mm.	In.	mm.	In.	mm.
09	.915	23.24	.450	11.43	.565	14.35	.160	4.06	1.033	26.24	.721	18.31	.554	14.07
15	1.065	27.05	.450	11.43	.715	18.16	.190	4.83	1.096	27.84	.783	19.89	.617	15.67
21	1.215	30.86	.450	11.43	.865	21.97	.220	5.59	1.127	28.63	.815	20.70	.649	16.48
25	1.315	33.40	.450	11.43	.965	24.51	.260	6.60	1.190	30.23	.877	22.28	.711	18.06
31	1.465	37.21	.450	11.43	1.115	28.32	.275	6.99	1.221	31.01	.908	23.06	.722	18.34
37	1.615	41.02	.450	11.43	1.265	32.13	.285	7.24	1.283	32.59	.971	24.66	.785	19.94
51	1.565	39.75	.495	12.57	1.215	30.86	.350	8.89	1.346	34.19	1.033	26.24	.867	22.02
51-2	1.965	48.91	.450	11.43	1.615	41.02	.285	7.24	1.346	34.19	1.033	26.24	.867	22.02
67	2.365	60.07	.450	11.43	2.015	51.18	.350	8.89	1.346	34.19	1.033	26.24	.867	22.02
69	1.865	47.37	.495	12.57	1.515	38.48	.350	8.89	1.346	34.19	1.033	26.24	.867	22.02
100	2.305	58.55	.540	13.72	1.800	45.72	.490	12.45	1.408	35.76	1.096	27.83	.930	23.62



EMI/RFI Elliptical Banding Backshell 507-175







17-7PH Stainless Steel Clips attach the backshell to the connector. These backshells accept standard and micro **BAND-IT®** shield termination straps.

Straight, 45° and Right Angle elliptical backshell provides plenty of working room for complicated wiring situations.

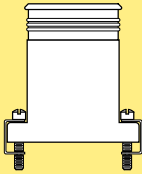
Rugged One-Piece Aluminum Shell with stainless steel hardware, available in standard nickel plating, or choose optional finishes.

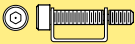
HOW TO ORDER 507-175 EMI BACKSHELLS

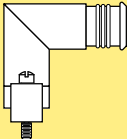
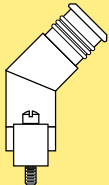
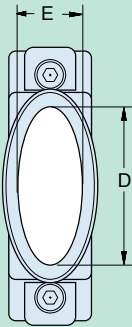
Series	Shell Finish	Connector Size	Cable Entry Code				Hardware Option		
Top Entry 507T175 	E – Chem Film (Alodyne) J – Cadmium, Yellow Chromate M – Electroless Nickel NF – Cadmium, Olive Drab ZZ – Gold	09	D	E	Available on Shell Size	Omit (Leave Blank) Fillister Head Jackscrew  H – Hex Head Jackscrew  E – Extended Jackscrew  F – Jackpost, Female 			
		15					Size	In.	mm.
		21	01	± .010	± 0.25		± .010	± 0.25	09 Thru 100
		25	02	.344	8.74		.290	7.37	15 Thru 100
		31	03	.494	12.55		.290	7.37	21 Thru 100
		37	04	.644	16.36		.290	7.37	25 Thru 100
		51	05	.744	18.90		.304	7.72	31 Thru 100
		51-2	06	.894	21.34		.304	7.72	37 Thru 100
Side Entry 507S175 		67	07	.994	25.25	.304	7.72	37 and 100	
		69	08	1.044	26.52	.304	7.72	100	
45° Entry 507E175 		100							
Sample Part Number 507E175 M 25 04									



MATERIALS (SEE ORDERING INFO FOR FINISH OPTIONS)

Shell	Aluminum Alloy 6061 -T6 Per QQ-A-200, QQ-A-225 (Machined Components) Aluminum Alloy 6061-T6 Per QQ-A-591 (A380) (Die-Cast Components)
Clips	17-7PH Stainless Steel
Jack screws, Washers, Jackposts	300 Series Stainless Steel, Passivated

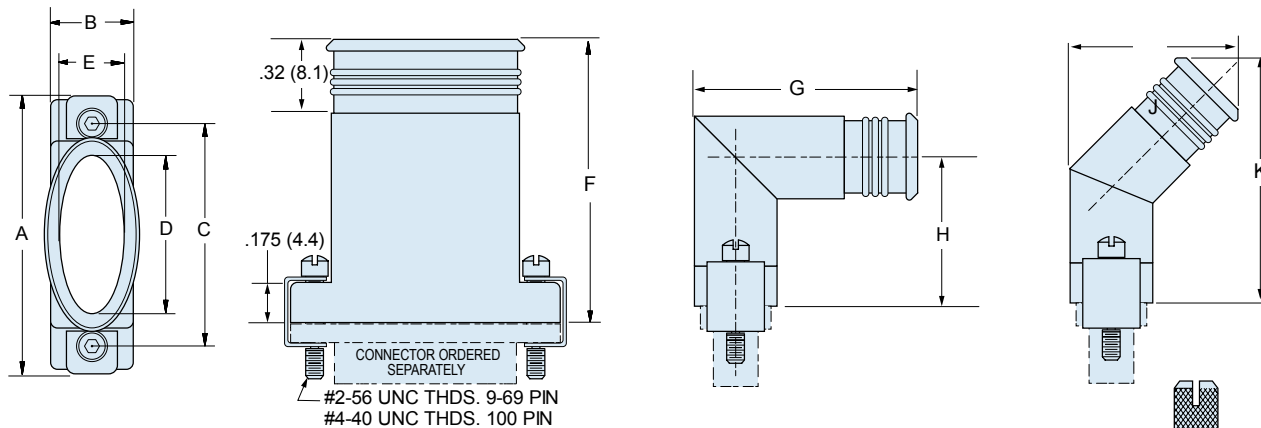

Cable Entry Code	D		E		Available on Shell Size
	In. ±.010	mm. ±0.25	In. ±.010	mm. ±0.25	
01	.344	8.74	.290	7.37	09 Thru 100
02	.494	12.55	.290	7.37	15 Thru 100
03	.644	16.36	.290	7.37	21 Thru 100
04	.744	18.90	.304	7.72	25 Thru 100
05	.894	21.34	.304	7.72	31 Thru 100
06	.994	25.25	.304	7.72	37 Thru 100
07	1.044	26.52	.304	7.72	37 and 100
08	1.024	26.01	.384	9.75	100

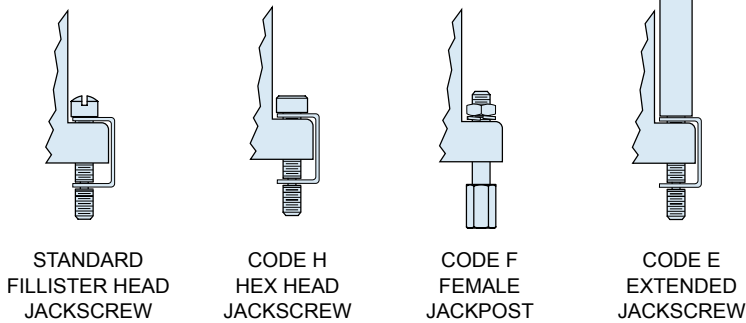

DIMENSIONS

Size	A Max.		B Max.		C		F Max.		G Max.		H Max.		J Max.		K Max.	
	In.	mm.	In.	mm.	In.	mm.	In.	mm.	In.	mm.	In.	mm.	In.	mm.	In.	mm.
09	.850	21.59	.370	9.40	.565	14.35	.782	19.86	.970	24.64	.668	16.97	.673	17.09	.851	21.62
15	1.000	25.40	.370	9.40	.715	18.16	.832	21.13	.970	24.64	.668	16.97	.673	17.09	.876	22.25
21	1.150	29.21	.370	9.40	.865	21.97	.882	22.40	.970	24.64	.668	16.97	.673	17.09	.901	22.89
25	1.250	31.75	.370	9.40	.965	24.51	.932	23.67	.990	25.15	.678	17.22	.700	17.78	.943	23.95
31	1.400	35.56	.370	9.40	1.115	28.32	.972	24.69	.990	25.15	.678	17.22	.700	17.78	.963	24.46
37	1.550	39.37	.370	9.40	1.265	32.13	.972	24.69	.990	25.15	.678	17.22	.700	17.78	.983	24.97
51	1.500	38.10	.410	10.41	1.215	30.86	1.092	27.74	1.030	26.16	.698	17.73	.758	19.25	1.050	26.67
51-2	1.910	48.51	.370	9.40	1.615	41.02	1.092	27.74	1.030	26.16	.698	17.73	.758	19.25	1.050	26.67
67	2.310	58.67	.370	9.40	2.015	51.18	1.092	27.74	1.030	26.16	.698	17.73	.758	19.25	1.050	26.67
69	1.810	45.97	.410	10.41	1.515	38.48	1.092	27.74	1.030	26.16	.698	17.73	.758	19.25	1.050	26.67
100	2.235	56.77	.460	11.68	1.800	45.72	1.157	29.39	1.090	27.69	.723	18.36	.824	20.93	1.130	28.70

EMI/RFI Elliptical Split Shell Banding Backshell



507-178



Split Backshell With Elliptical Cable Entry provides added room for larger wire bundles. Terminate cable shields with **BAND-IT®** microbands. This backshell features floating male screwlocks which allow full mating of the connector before the screws are fastened.

Rugged Aluminum housing with stainless steel hardware, available in standard nickel plating, or choose optional finishes.

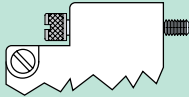
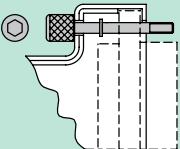
HOW TO ORDER 507-178 EMI BACKSHELLS

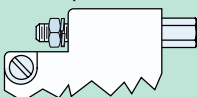
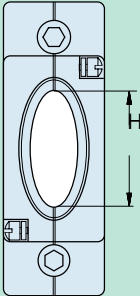
Series	Shell Finish	Connector Size	Cable Entry Code	EMI Band Strap Option	Hardware Option					
507-178	E – Chem Film (Alodyne) J – Cadmium, Yellow Chromate M – Electroless Nickel NF – Cadmium, Olive Drab Z2 – Gold	09 15 21 25 31 37 51 51-2 67 69 100	H In. mm. Available on Code ± .010 ± 0.25 Shell Size	OMIT - Band Strap Not Supplied B – Microband Supplied (600-057) K – Coiled Microband Supplied (600-057-1)	Omit for Standard Slot Head Male Screwlock  H – Hex Socket Head Screwlock  E – Extended Screwlock  FF – Jackpost, Female 					
			04 .250 6.35 09, 15, 21							
			05 .312 7.92 15 Thru 31							
			06 .375 9.53 21 Thru 51							
			07 .437 11.10 25 Thru 51							
			08 .500 12.70 25 Thru 51							
			09 .562 14.27 31 Thru 100							
			10 .625 15.88 31 Thru 100							
			11 .688 17.48 37 Thru 100							
			12 .750 19.05 37 Thru 100							
			13 .812 20.62 37,51-2,67,69,100							
			14 .875 22.23 51-2, 67, 69, 100							
			15 .938 23.83 51-2, 67, 69, 100							
			16 1.000 25.40 51-2, 67, 69, 100							
										
			Sample Part Number							
			507-178			M	25	06	K	F



MATERIALS (SEE ORDERING INFO FOR FINISH OPTIONS)

Shell	Aluminum Alloy
Jackscrews, Washers, Jackposts	300 Series Stainless Steel, Passivated

Shell size 09 may be supplied with optional configuration J Dimension of 1.140 (28.96) Max.

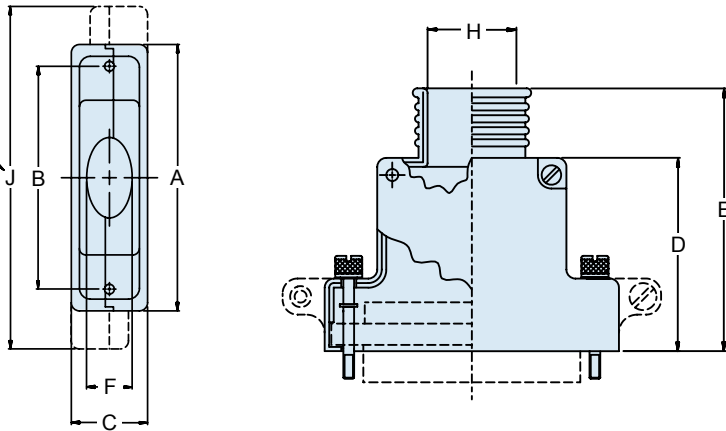

CABLE ENTRY			
Code	H		Available on Shell Size
	In. ± .010	mm. ± 0.25	
04	.250	6.35	09, 15, 21
05	.312	7.92	15 Thru 31
06	.375	9.53	21 Thru 51
07	.437	11.10	25 Thru 51
08	.500	12.70	25 Thru 51
09	.562	14.27	31 Thru 100
10	.625	15.88	31 Thru 100
11	.688	17.48	37 Thru 100
12	.750	19.05	37 Thru 100
13	.812	20.62	37,51-2,67,69,100
14	.875	22.23	51-2, 67, 69, 100
15	.938	23.83	51-2, 67, 69, 100
16	1.000	25.40	51-2, 67, 69, 100

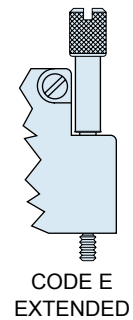
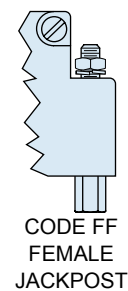
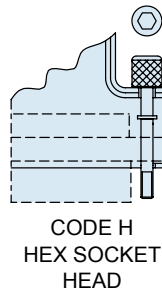
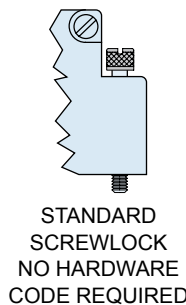

DIMENSIONS

Size	A Max.		C Max.		B		F		F Max.		G Max.	
	In.	mm.	In.	mm.	In.	mm.	In. ± .010	mm. ± 0.25	In.	mm.	In.	mm.
09	.915	23.24	.450	11.43	.565	14.35	.160	4.06	1.033	26.24	.721	18.31
15	1.065	27.05	.450	11.43	.715	18.16	.190	4.83	1.096	27.84	.783	19.89
21	1.215	30.86	.450	11.43	.865	21.97	.220	5.59	1.127	28.63	.815	20.70
25	1.315	33.40	.450	11.43	.965	24.51	.260	6.60	1.190	30.23	.877	22.28
31	1.465	37.21	.450	11.43	1.115	28.32	.275	6.99	1.221	31.01	.908	23.06
37	1.615	41.02	.450	11.43	1.265	32.13	.285	7.24	1.283	32.59	.971	24.66
51	1.565	39.75	.495	12.57	1.215	30.86	.350	8.89	1.346	34.19	1.033	26.24
51-2	1.965	49.91	.450	11.43	1.615	41.02	.350	8.89	1.346	34.19	1.033	26.24
67	2.365	60.07	.450	11.43	2.015	51.18	.350	8.89	1.346	34.19	1.033	26.24
69	1.865	47.37	.495	12.57	1.515	38.48	.350	8.89	1.346	34.19	1.033	26.24
100	2.305	58.55	.540	13.72	1.800	45.72	.490	12.45	1.408	35.76	1.096	27.83

Saddle Bar Strain-Relief Backshell

507-198



507-198 Strain Relief Backshells feature saddle bar cable clamps for easy installation.

MATERIALS

Shell	Aluminum Alloy 6061 -T6
Clips	17-7PH Stainless Steel
Hardware	300 Series Stainless Steel

HOW TO ORDER 507-198 STRAIN RELIEF BACKSHELLS

Series	Shell Finish	Connector Size	
507-198	E - Chem Film	09	51
	J - Cadmium, Yellow Chromate	15	51-2
	M - Electroless Nickel	21	67
	NF - Cadmium, Olive Drab	25	69
	Z2 - Gold	31	100
		37	
Sample Part Number			
507-198	M	25	

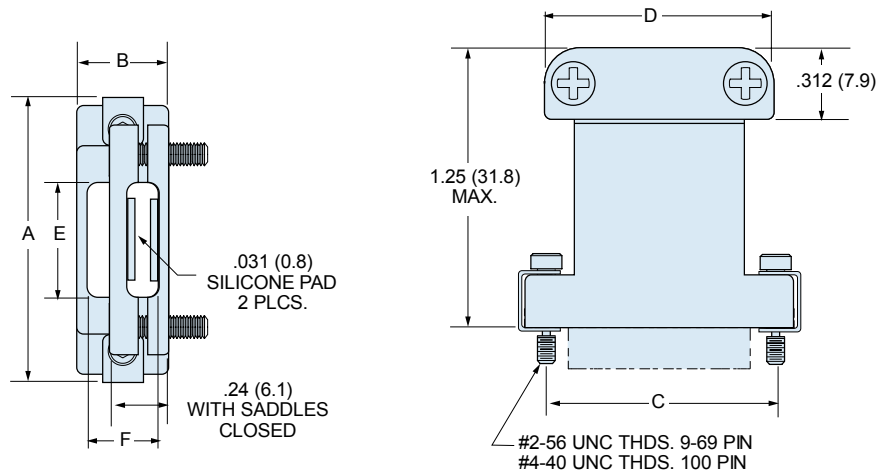

DIMENSIONS

Size	A Max.		B Max.		C		D Max.		E		F	
	In.	mm.	In.	mm.	In.	mm.	In.	mm.	In.	mm.	In.	mm.
09	.850	21.59	.420	10.67	.565	14.35	.840	21.34	.31	7.87	.31	7.87
15	1.000	25.40	.420	10.67	.715	18.16	.910	23.11	.38	9.65	.31	7.87
21	1.150	29.21	.420	10.67	.865	21.97	.970	24.64	.44	11.18	.31	7.87
25	1.250	31.75	.420	10.67	.965	24.51	1.030	26.16	.50	12.70	.31	7.87
31	1.400	35.56	.420	10.67	1.115	28.32	1.080	27.43	.55	13.97	.31	7.87
37	1.550	39.37	.420	10.67	1.265	32.13	1.130	28.70	.60	15.24	.31	7.87
51	1.500	38.10	.470	11.94	1.215	30.86	1.080	27.43	.55	13.97	.36	9.14
51-2	1.910	48.51	.420	10.67	1.615	41.02	1.480	37.59	.95	24.13	.31	7.87
67	2.310	58.67	.420	10.67	2.015	51.18	1.880	47.75	1.35	34.29	.31	7.87
69	1.810	45.97	.470	11.94	1.515	38.48	1.380	35.05	.85	21.59	.36	9.14
100	2.235	56.77	.510	12.95	1.800	45.72	1.650	41.91	1.00	25.40	.40	10.04

Fast Delivery!

On Glenair's Complete Selection of Micro-D Connector Savers, Hardware and Accessories

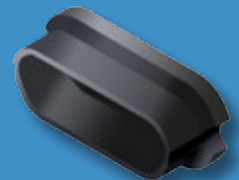
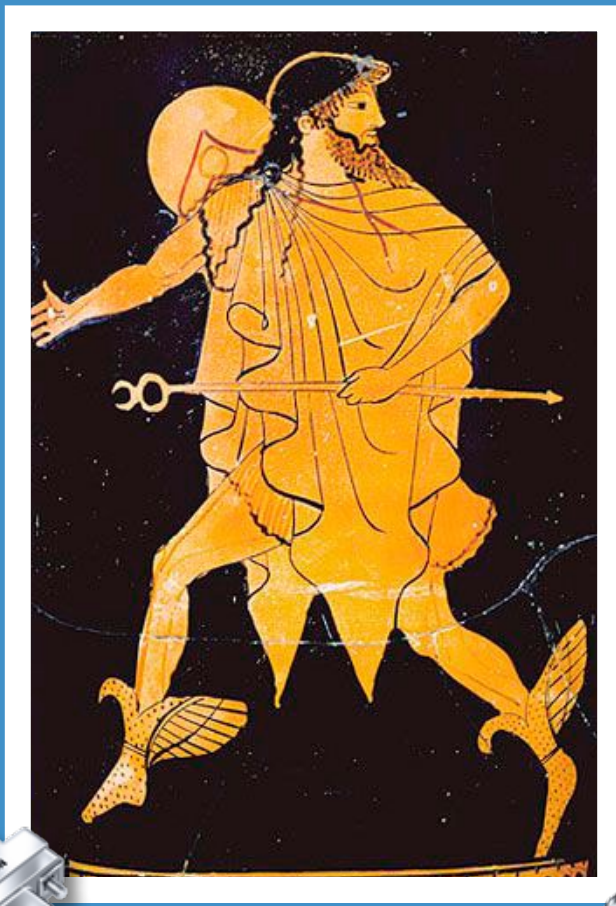

1211 Air Way

Glendale, California 91201-2497

Telephone: 818-247-6000 · Facsimile: 818-500-9912 · E-mail: sales@glenair.com

United States · United Kingdom · Germany · Nordic · France · Italy · Spain · Japan

www.glenair.com